

### 90° corner table attachment

Item.no IS-80-TA04-N

**Complete with:**

1 top shelf, 1 bottom shelf  
1 posts, 2 T-box connectors  
and 4 feet

Can be used with the  
**Wave, Compact and Exhibit system.**



**Extra**  
Bag for 90° corner table  
Item IS-80-TB03



90° inner corner



90° outer corner



90° inner/outer corner



Screw in the 4 adjustable feet



Attach the bottom table to the system



Attach the extension posts  
and connect the T-ox and the  
front post

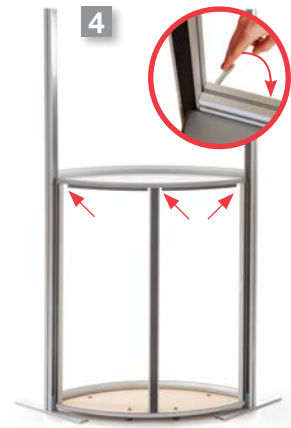

Attach the top table and  
lock the fast clamps.



Attach the top post and build up the rest of  
your system



Start with table unit the and attach the panels  
at the wall



Go further with the rest of the panels.  
You are now ready !



## Graphic production

### Wall graphic

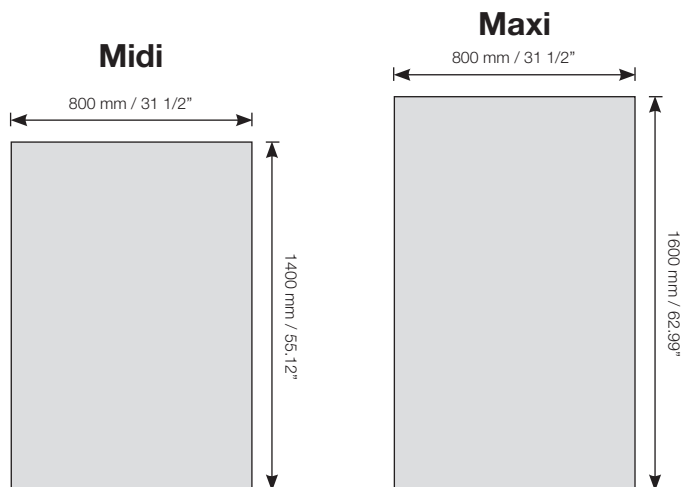

### 90° corner graphic

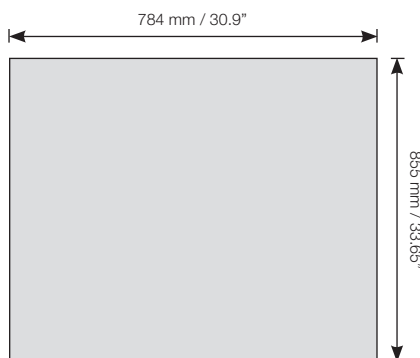

A template for the graphic panel production can be downloaded at:  
[www.isoframe.com/counters/downloads](http://www.isoframe.com/counters/downloads)

## Graphic panel attachments

### Accessories

**Kickers & Hangers**  
800 mm / 31 1/2" Item: IS-800-KHN

**Magnetic tape** (not incl.)  
12 mm / 0.5", Item: 82281  
24 mm / 1", Item: 82282

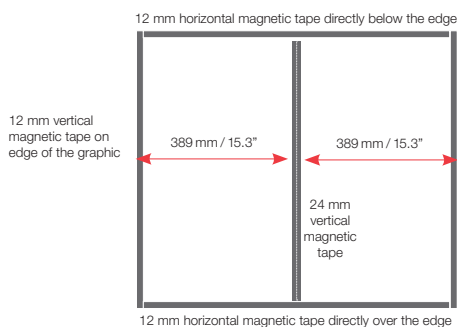
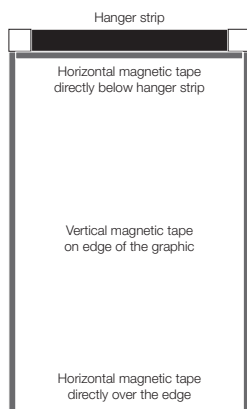

### Printer material

We recommend the following material:

**Poster paper:** 180 gr / 0.4 lb.  
*The printed graphic panels must be laminated before use.*  
Front side: 125 microns (0,125 mm) / 0.005" "deep crystal"  
Reverse side: 250 microns (0,250 mm) / 0.010" "stop light"

**Polyester film:** 330-370 microns (0,350 mm) / 0.013-0.015"  
Top laminate: 125 microns (0,125 mm) / 0.005" "deep crystal"

### Mounting of Hangers

Hangers to be fixed at the top of the wall graphic panel (reverse side).

### Mounting of Magnetic Tape

Magnetic tape to be fixed on the graphic panels. (See picture)

**IMPORTANT** Carefully mount the magnetic tape slightly inset from the edge of the graphic panel by approximately 0,25 mm / 0.010". Once mounted, a very thin straight white line should show between the edge of the graphic and the outside edge of the magnetic tape. Do not exceed 0,5 mm / 0.020".

### Application Techniques

To obtain optimum adhesion, the bonding surfaces must be well unified, clean and dry. Typical surface cleaning solvents are isopropyl alcohol/water mixture (rubbing alcohol) or heptane.

Note: Be sure to follow solvent manufacturer's precautions and directions for use when using solvents.